

The background of the slide is a solid dark orange color, overlaid with a pattern of lighter orange, stylized autumn leaves. The leaves are scattered across the frame, with some showing prominent veins. The overall aesthetic is warm and seasonal.

# **Benefits of Asset Management Culverts**

**Presented by:**

**Randall Smith**

**Kearney County Highway Superintendent**

**Minden, NE**

**Email: [kcroad@gtmc.net](mailto:kcroad@gtmc.net)**

The background of the slide is a solid dark brown color. Overlaid on this background are several large, stylized leaves in various shades of brown and tan, creating a layered, autumnal effect. The leaves are scattered across the frame, with some appearing more prominent than others.

**Where is  
Kearney County,  
Nebraska?**

# KEARNEY COUNTY

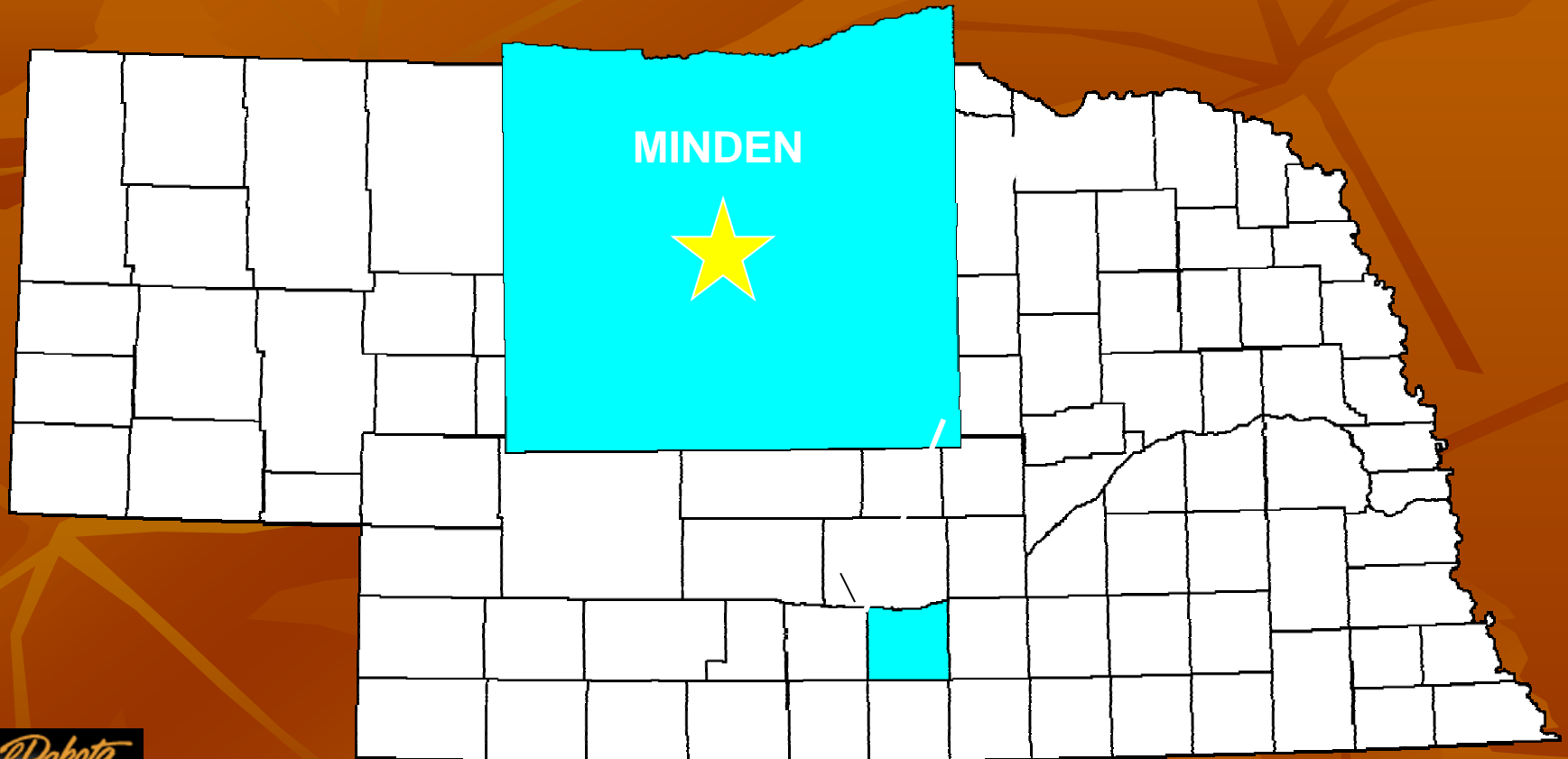



## Welcome

### Kearney County Minden Nebraska

Our new website was brought online in June 2010 with the help of MIPS Inc. MIPS Inc is the Technology Services Division of the Nebraska Association of County Officials (NACO). NACO's website address is [www.nacone.org](http://www.nacone.org)

We invite you to browse our web site to learn about our various County offices and the services Kearney County, Nebraska offers its citizens. Courthouse hours are from 8:30 - 5:00 Monday - Friday except on holidays.

This web site contains information about County programs, services, departments and offices, as well as helpful information on commonly asked questions. We encourage you to use this site frequently to access agendas and minutes of the Board of County Supervisors.

[Kearney County GIS system](#)

[Kearney County Assessor Property Search & Mapping GIS system](#)

### Kearney County Courthouse

**Address**  
424 N Colorado  
Minden, NE 68959

**Phone**  
308-832-2723

**Office Hours**  
8:30 a.m. - 5:00 p.m.

#### Location

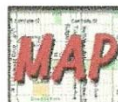

Our online forms and documents are in PDF format. If you do not have the latest Adobe's PDF reader installed, click on the Adobe PDF image below.



16,244

Hits since August 1, 2010

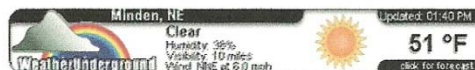

# Welcome to Kearney County Nebraska

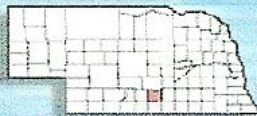
[Home](#)[Kearney Cnty](#)[Offices](#)[Calendar](#)[Contacts](#)[Links](#)

## Kearney County



- **Land Area:** 516 square miles
- **Population (2002):** 6,629
- **County Seat:** Minden
- **Towns and Population (2000):** Axtell, 707; Heartwell, 69; Minden, 2,749; Norman, 48; Wilcox, 349.
- **Public School Districts:** Axtell Community School, Axtell; Minden Public Schools, Minden; Wilcox-Hildreth Public Schools, Wilcox.



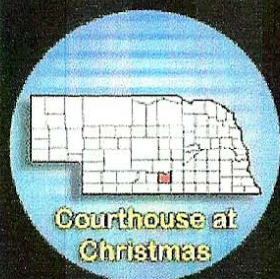

# Welcome to Kearney County Nebraska

[Home](#)[Kearney Cnty](#)[Offices](#)[Calendar](#)[Contacts](#)[Links](#)

## Department of Roads

### 2011 Office Hours

Jan 1 thru March 13

7:30 am to 4:00 pm (Mon-Fri)

March 14 thru Nov 6

7:00 am to 5:30 pm (Mon-Thurs)

Nov 7 thru Dec 31

7:30 am to 4:00 pm (Mon-Fri)

### Phone

308-832-2854

### Fax

308-832-0401

### Location

1124 E 9th

Minden, NE 68959

### Links

[Nebraska Department of Roads](#)

All online PDF's are made using Adobe® Acrobat®, you will need Adobe® Acrobat® Reader® in order to view the online forms. If you do not have Adobe® Acrobat® Reader® click the logo below to acquire the latest version



[Randall Smith](#)

Highway Superintendent

The following permits are Editable PDF's, which allow you to view the form through your browser and type in requested information. You can then print off the form and send it to the appropriate Kearney County Department.

[Application for Buried Line Permit](#)

[Application for Driveway Permit](#)

[Application for Overwidth Moving Permit](#)

The Highway Superintendent is required to submit an annual budget and a One & Six Year Road Plan to the Board of Supervisors and the Nebraska DOR. The budget should reflect the road maintenance needs and construction improvements on or before April 1st of each year.

The Board of Supervisors, with the assistance of the Highway Superintendent, must prepare and adopt a One and Six Year Road Plan which includes the following items:

1. A project accomplishment list for the next fiscal year. [Map of the 2011 Construction Projects](#)
2. A project priority list for the following five fiscal years. [Map of the 2011-2016 Construction Projects](#)

The project accomplishment list and annual budget may be revised only if unforeseen circumstances occur. Any revision must be approved by the Nebraska Board of Classification and Standards. The priority of improvement of improvement of roads is within the sound discretion of the Board of Supervisors.

Kearney County operates 8 motor grader routes to cover 788 miles of gravel and 60 miles of hard surface roads. Each operator has an average of 98 miles per route. It takes approximately two weeks to blade over an entire route. Kearney County Road Department personnel are responsible for sign, bridge, asphalt, and equipment maintenance along with vegetation control and construction projects.

The background of the slide is a solid dark brown color, overlaid with a pattern of stylized, semi-transparent autumn leaves in various shades of brown and tan. The leaves are scattered across the entire frame, creating a textured, seasonal aesthetic.

Kearney County operates 8 motor grader routes to cover 788 miles of gravel and 60 miles of hard surface roads.

Each operator has an average of 98 miles per route.  
It takes approximately two weeks to blade over an entire route.

Kearney County Road Department personnel are responsible for sign, bridge, asphalt, and equipment maintenance along with vegetation control and construction projects.

At the present time we have 14 full time operators.



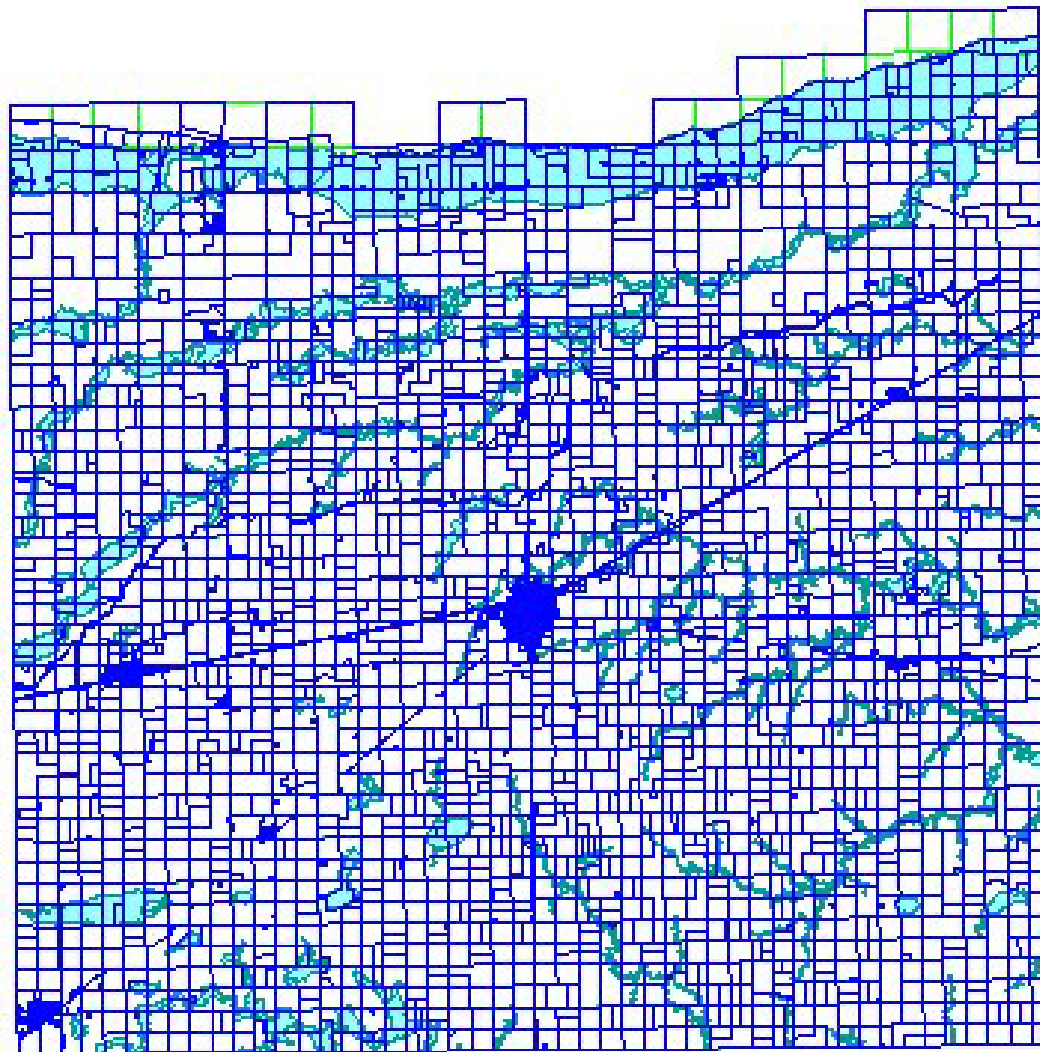

0 10mi

R 16 W

R 15 W

R14 W

R13 W

# Kearney County

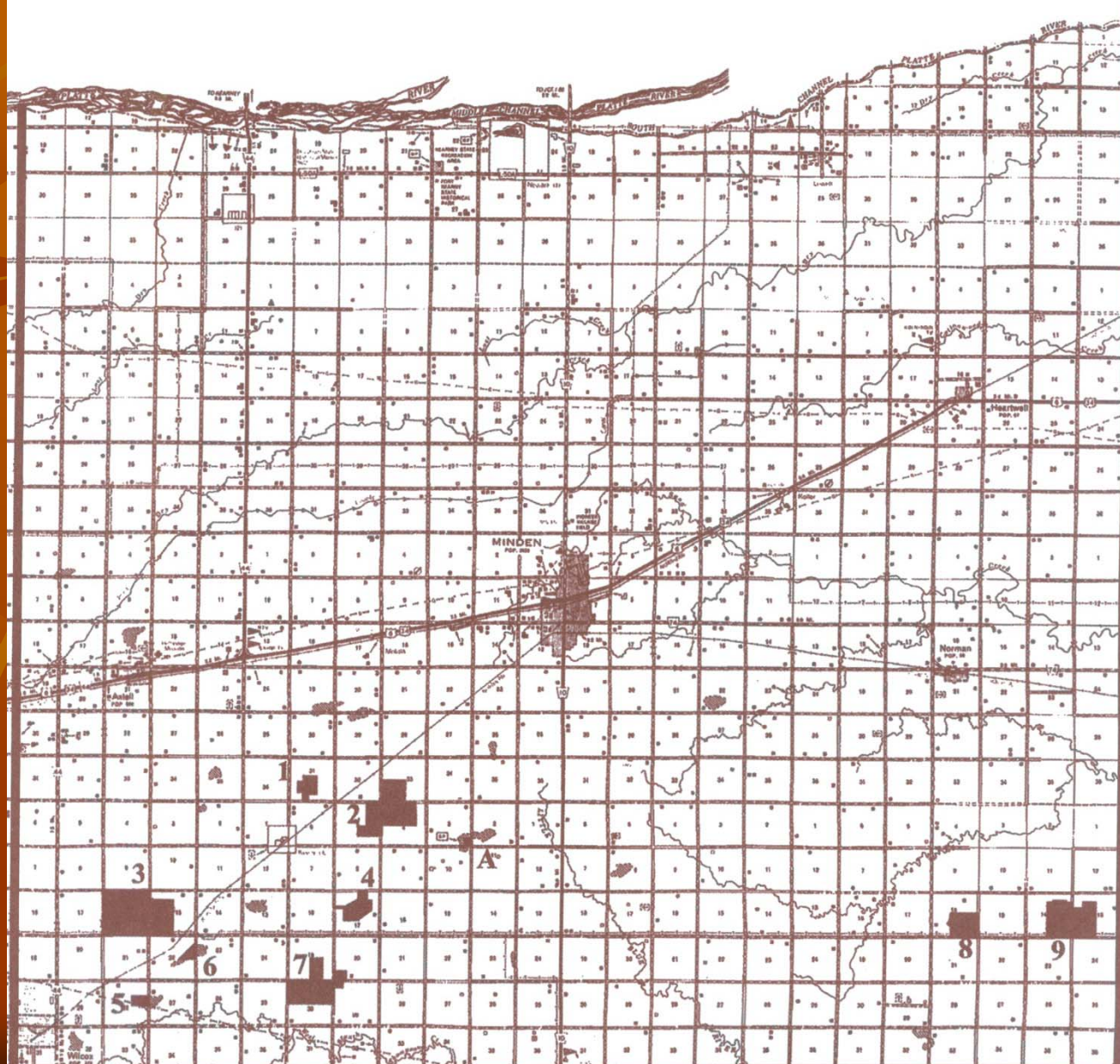

T8N

T7N

T6N

T5N

- 
- The background of the slide is a solid brown color with a faint, stylized pattern of autumn leaves in a lighter shade of brown. The leaves are scattered across the frame, with some showing prominent veins.
- Less than 20' water way structures
  - Metal pipes

- 
- Latitude, Longitude
  - Culvert Number
  - Diameter
  - Length
  - Shape / Material
  - Condition of culvert/ditch
  - Owner
  - Number of spans/ max span length
  - Inspection date
  - Comments

# GPS your Culvert and Bridge Structures













[Home](#) [County Offices](#) [Contacts](#) [Elected Officials](#) [Links](#)

## Search

Address:  City:  Search Section:  Township:  Range:  Search

## Legend

- | Show                                | ID | Name              |
|-------------------------------------|----|-------------------|
| <input type="checkbox"/>            |    | Bridges           |
| <input checked="" type="checkbox"/> |    | Culverts          |
| <input checked="" type="checkbox"/> |    | Streets           |
| <input checked="" type="checkbox"/> |    | Parcels           |
| <input checked="" type="checkbox"/> |    | Sections          |
| <input type="checkbox"/>            |    | Floodplain        |
| <input type="checkbox"/>            |    | Zoning            |
| <input type="checkbox"/>            |    | School Districts  |
| <input type="checkbox"/>            |    | Voting Precincts  |
| <input type="checkbox"/>            |    | Council           |
| <input type="checkbox"/>            |    | County Board      |
| <input type="checkbox"/>            |    | Fire Districts    |
| <input type="checkbox"/>            |    | State Legislature |
| <input checked="" type="checkbox"/> |    | Imagery           |

Update

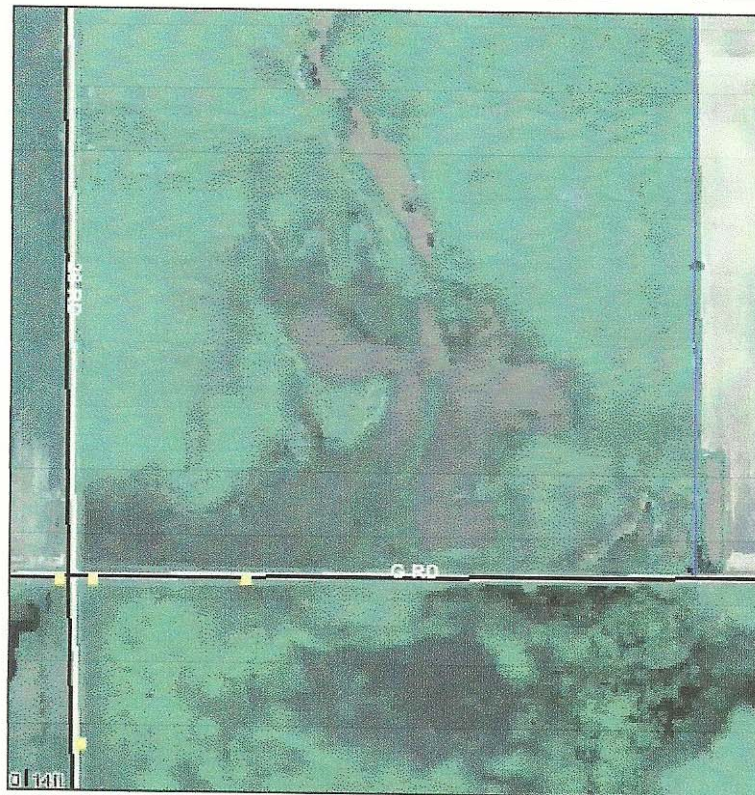

## Tools

- Zoom In
- Zoom Out
- Pan
- Full Extent
- Identify
- Buffer

[Map Help](#)

## Identified Features

*No features identified.*





## Gleason Hydrology Restoration

The U.S. Fish and Wildlife Service (USFWS) is working cooperatively with local landowners to restore the natural hydrology of the watershed surrounding the Gleason Waterfowl Production Area (WPA) in Kearney County. Discussion between USFWS personnel and owners of nearby properties helped identify irrigation re-use pits that were no longer needed due to conversion from gravity irrigation to more efficient pivot irrigation systems. In 2003, the USFWS Partners for Fish and Wildlife program provided cost share and technical assistance to encourage the neighbors to fill these abandoned pits.

Merlyn Stadler agreed to have his 1/3 mile long pit, located adjacent to Gleason WPA, filled using silt that had washed into the wetland over several decades. Now that this large pit has been filled, natural run-off is able to reach the WPA, improving the wetland's hydrology.

Removing unwanted silt from the wetland encouraged the growth of plants that are valuable as food and cover for wildlife. Silt removal also increased the wetland's ability to store water, enhancing flood protection for neighbors. Three more pits within the Gleason WPA watershed boundary are expected to be filled yet this year.



**Photos courtesy of USFWS**

**Top:** Aerial of Gleason WPA.

**Lower Left:** Construction work on Gleason.

**Lower Right:** Stadler pit.



[Home](#)[County Offices](#)[Contacts](#)[Elected Officials](#)[Links](#)

## Search

Address: City: 

Search

Section: Township: Range: 

Search

## Legend

| Show                                | ID | Name              |
|-------------------------------------|----|-------------------|
| <input type="checkbox"/>            |    | Bridges           |
| <input checked="" type="checkbox"/> |    | Culverts          |
| <input checked="" type="checkbox"/> |    | Streets           |
| <input checked="" type="checkbox"/> |    | Parcels           |
| <input checked="" type="checkbox"/> |    | Sections          |
| <input type="checkbox"/>            |    | Floodplain        |
| <input type="checkbox"/>            |    | Zoning            |
| <input type="checkbox"/>            |    | School Districts  |
| <input type="checkbox"/>            |    | Voting Precincts  |
| <input type="checkbox"/>            |    | Council           |
| <input type="checkbox"/>            |    | County Board      |
| <input type="checkbox"/>            |    | Fire Districts    |
| <input type="checkbox"/>            |    | State Legislature |
| <input checked="" type="checkbox"/> |    | Imagery           |
| Update                              |    |                   |



## Tools

- Zoom In
- Zoom Out
- Pan
- Full Extent
- Identify
- Buffer

[Map Help](#)

## Identified Features

*No features identified.*

